

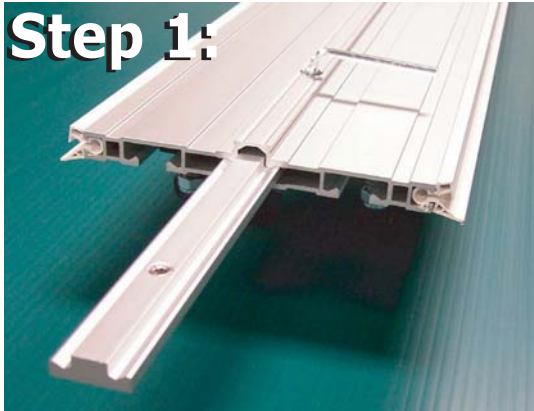

Can't find the Connectors? you'll find them in the bottom track of the guide during shipping.

IMPORTANT! DO NOT OVERTIGHTEN THE CONNECTORS!

They are designed to self align with minimum tightening of the set screws. Overtightening will dent the aluminum on the top of the guide rail.



Step 1:

Step 2:

Step 3:

Only for systems over 100"...
Put a connector in the center and tighten it. (lightly)

Insert the other two connectors halfway in and tighten them lightly

Slide the two guides together (all the way) and lightly tighten the remaining screws

The center connector is only necessary when connecting guide rails over 100". For 100" set-ups and below, (Ex. the SGS-1 system) You only need two side connectors.

hint: vibrations can cause the set screws to loosen.
To prevent loosening, you can wrap teflon tape around the set screws.

IMPORTANT! DO NOT OVERTIGHTEN THE SMART CLAMPS!



Smart Table

Smart Router

Other additions to the EZ Smart Guide System

Visit our website, or your local store to see the Smart Table, and the Smart Router.

The Smart Table allows you to cut anywhere without cutting the table and without having any drop-offs

The Smart Router Kit is like having a "Manual" CNC woodworking center in a box.

Now, Stop imagining, Start building, and please...send us some photos of your creations. (because woodworking is art and art serves better when shared with others.)

Welcome to eurekazone!

